

Isokern fireplaces

Specified most by architects,
designers, builders & homeowners.

indoor or outdoor
modular masonry
fireplaces

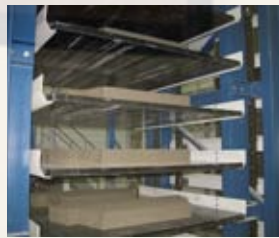



The Isokern brand has been a part of the construction industry for over sixty years. Known for their exceptional insulation value and ease of installation, Isokern products were introduced in the United States in 1987. For the past 22 years, Isokern has been at the forefront of modular masonry hearth systems in the construction and remodeling industries. Isokern is synonymous with quality, efficiency and affordability.

Isokern products are made with volcanic pumice extracted from the Hekla Volcano in Iceland. Pumice stone is a natural material and is the primary component of the Isokern makeup. Unlike lower altitude pumice, Icelandic pumice contains less organic material in its make up resulting in a dense, cleaner raw material. This pumice does not expand or contract with temperature change, reducing the possibility of cracking and structural damage. Pumice is also lightweight, allowing for quick and consistent fireplace and chimney system installation.

Isokern systems are manufactured at the Earthcore Industries, LLC Manufacturing Plant, located in Chesapeake, Virginia, under strict quality assurance and testing guidelines. This detail orientated approach ensures that each firebox or chimney component produced measures up to the highest of standards. Due to its modular construction, Isokern systems can be built in a shorter time and each system is similar with only slight variations in installation techniques.



Made in the U.S.A by Earthcore Industries, LLC



Isokern modular masonry fireplaces

Sizes and designs for any application.

“behind every beautiful fireplace is an Isokern”

Over 100,000 units installed.



MAGNUM



STANDARD



IBV



FIRE-LITE



VENT-FREE

APPLICATIONS

Indoor	•	•	•	•	•
Outdoor	•	•		•	•
2 Sided		36" only			•
Commercial	•	•	•	•	•
Residential	•	•	•	•	•
Custom Finish	•	•	•	•	•
Combustible Floor Installation			•	•	•
Masonry Foundation Installation	•	•	•	•	•

VENTING

Vented Masonry Chimney	•	•			
Vented Metal Chimney	•	•	•	•	
Unvented (no chimney needed)					•
eDamper (electronic damper)			•		

FUEL TYPES

Wood	•	•		•	
Liquid Propane	•	•	•	•	•
Natural Gas	•	•	•	•	•

HEARTH OPENING SIZES

28"					
36"	•	•	•	•	•
42"	•	•		•	•
46"		•	•	•	•
48"	•			•	
60"	•				
72"	•				

Isokern fireplaces can be finished with a variety of materials...natural stone
brick
stucco
veneers
cultured stone



ISOKERN

modular masonry
construction
superior heat transfer &
insulation value

www.isokern.net - 800 642 2920

the Magnum Series

1.800.642.2920



The Magnum Series has the largest opening available in the market with true finished openings of 36", 42" and 48" width with a standard 36" height. These larger openings are ideal for more dramatic interior and exterior applications. With the proprietary straight-back interior design and innovative contoured shelf, the Magnum Series is second to none in efficiency, performance and custom design flexibility.

Applications

- | | |
|--|--|
| <input checked="" type="checkbox"/> Indoor | <input checked="" type="checkbox"/> Custom Finished |
| <input checked="" type="checkbox"/> Outdoor | <input type="checkbox"/> 2 Sided Availability |
| <input checked="" type="checkbox"/> Wood | <input type="checkbox"/> Unvented |
| <input checked="" type="checkbox"/> Natural Gas | <input checked="" type="checkbox"/> Isokern DM Chimney |
| <input checked="" type="checkbox"/> LP | <input checked="" type="checkbox"/> Metal Chimney |
| <input checked="" type="checkbox"/> Combustible Floor Installation - See Fire-Lite | |

Sizes

- | | |
|---|------------------------------|
| <input checked="" type="checkbox"/> 36" | <input type="checkbox"/> 60" |
| <input checked="" type="checkbox"/> 42" | <input type="checkbox"/> 72" |
| <input checked="" type="checkbox"/> 48" | |



the Magnum Series 60" - 72"

The largest, listed fireplace available in the Isokern product line. With openings of sixty and seventy-two inches, this fireplace system is ideal for large custom homes, hotel or multi-housing lobbies and restaurants. Similar to the smaller Magnum fireplaces in the series, this fireplace system offers a straight-wall, shallow depth design for a more traditional fireplace look.



Applications

- | | |
|---|--|
| <input checked="" type="checkbox"/> Indoor | <input checked="" type="checkbox"/> Custom Finished |
| <input checked="" type="checkbox"/> Outdoor | <input type="checkbox"/> 2 Sided Availability |
| <input checked="" type="checkbox"/> Wood | <input type="checkbox"/> Unvented |
| <input checked="" type="checkbox"/> Natural Gas | <input checked="" type="checkbox"/> Isokern DM Chimney |
| <input checked="" type="checkbox"/> LP | <input checked="" type="checkbox"/> Metal Chimney |
| <input type="checkbox"/> Combustible Floor Installation | |

Sizes

- | | |
|------------------------------|---|
| <input type="checkbox"/> 36" | <input checked="" type="checkbox"/> 60" |
| <input type="checkbox"/> 42" | <input checked="" type="checkbox"/> 72" |
| <input type="checkbox"/> 46" | |

the Standard Series

1.800.642.2920



The Standard Series was the first Isokern introduced in North America over 15 years ago. With a proven record in satisfying a broad range of diverse projects, the Standard Series is still popular for interior and exterior fireplace designs. Like other Isokern fireplace systems the Standard Series can be custom finished to suit specific design and architectural needs.

Applications

- | | |
|--|--|
| <input checked="" type="checkbox"/> Indoor | <input checked="" type="checkbox"/> Custom Finished |
| <input checked="" type="checkbox"/> Outdoor | <input checked="" type="checkbox"/> 2 Sided Availability |
| <input checked="" type="checkbox"/> Wood | <input type="checkbox"/> Unvented |
| <input checked="" type="checkbox"/> Natural Gas | <input checked="" type="checkbox"/> Isokern DM Chimney |
| <input checked="" type="checkbox"/> LP | <input checked="" type="checkbox"/> Metal Chimney |
| <input checked="" type="checkbox"/> Combustible Floor Installation - See Fire-Lite | |

Sizes

- | | |
|---|------------------------------|
| <input checked="" type="checkbox"/> 36" | <input type="checkbox"/> 60" |
| <input checked="" type="checkbox"/> 42" | <input type="checkbox"/> 72" |
| <input checked="" type="checkbox"/> 46" | |



the Isokern B-Vent Series (IBV)

The Isokern B-Vent (IBV) is the only field assembled, modular refractory, gas only, top-vented appliance in the market today. It can be installed directly on a combustible floor system while still meeting ANSI Z21.50 guidelines. The IBV is a complete fireplace system including the required components, gas log burner, and a gas log set.



Applications

- | | |
|--|---|
| <input checked="" type="checkbox"/> Indoor | <input checked="" type="checkbox"/> Custom Finished |
| <input type="checkbox"/> Outdoor | <input type="checkbox"/> 2 Sided Availability |
| <input type="checkbox"/> Wood | <input type="checkbox"/> Unvented |
| <input checked="" type="checkbox"/> Natural Gas | <input type="checkbox"/> Isokern DM Chimney |
| <input checked="" type="checkbox"/> LP | <input checked="" type="checkbox"/> Metal Chimney |
| <input checked="" type="checkbox"/> Combustible Floor Installation | |

Sizes

- | | |
|---|------------------------------|
| <input checked="" type="checkbox"/> 36" | <input type="checkbox"/> 60" |
| <input type="checkbox"/> 42" | <input type="checkbox"/> 72" |
| <input checked="" type="checkbox"/> 46" | |

the Fire-Lite Application for Magnum & Standard



*anchor plate with
inswool (required)*



The Fire-Lite Series is an application for the Standard or Magnum* Series fireplaces allowing the fireplace system to be placed directly on a combustible surface. This innovative application now enables architects, builders and designers to specify a fireplace system in projects that could not include one in the past.

*Contact the Technical Department at 800.642.2920 for more information.

Applications

- | | |
|--|---|
| <input checked="" type="checkbox"/> Indoor | <input checked="" type="checkbox"/> Custom Finished |
| <input checked="" type="checkbox"/> Outdoor | <input type="checkbox"/> 2 Sided Availability |
| <input checked="" type="checkbox"/> Wood | <input type="checkbox"/> Unvented |
| <input checked="" type="checkbox"/> Natural Gas | <input type="checkbox"/> Isokern DM Chimney |
| <input checked="" type="checkbox"/> LP | <input checked="" type="checkbox"/> Metal Chimney |
| <input checked="" type="checkbox"/> Combustible Floor Installation | |

Sizes

- | | |
|---|---|
| <input checked="" type="checkbox"/> 36" | <input checked="" type="checkbox"/> 48" |
| <input checked="" type="checkbox"/> 42" | <input type="checkbox"/> 60" |
| <input checked="" type="checkbox"/> 46" | <input type="checkbox"/> 72" |



the Vent-Free Series

Enjoy the elegance of a true masonry fireplace in areas where a chimney may not be feasible with the Vent-Free Series. The Vent-Free Series can be installed in more non-traditional areas of the house such as under a window or within an entertainment area. With it's large finished openings and double-sided availability, the Vent-Free Series can be used in any new home or remodeling design.



Applications

- | | |
|--|--|
| <input checked="" type="checkbox"/> Indoor | <input checked="" type="checkbox"/> Custom Finished |
| <input checked="" type="checkbox"/> Outdoor | <input checked="" type="checkbox"/> 2 Sided Availability |
| <input type="checkbox"/> Wood | <input checked="" type="checkbox"/> Unvented |
| <input checked="" type="checkbox"/> Natural Gas | <input type="checkbox"/> Isokern DM Chimney |
| <input checked="" type="checkbox"/> LP | <input type="checkbox"/> Metal Chimney |
| <input checked="" type="checkbox"/> Combustible Floor Installation | |

Sizes

- | | |
|---|------------------------------|
| <input checked="" type="checkbox"/> 36" | <input type="checkbox"/> 60" |
| <input checked="" type="checkbox"/> 42" | <input type="checkbox"/> 72" |
| <input checked="" type="checkbox"/> 46" | |

Outdoor Fireplace Applications

1.800.642.2920

Fireplace Options



Magnum Series

Hearth Size

- 36"
- 42"
- 48"
- 60"
- 72"

Weight*

- 1360 lbs
- 1450 lbs
- 1600 lbs
- 2700 lbs
- 2900 lbs



Standard Series

Hearth Size

- 36"
- 42"
- 46"

Weight*

- 1050 lbs
- 1305 lbs
- 1150 lbs



Vent-Free Series

Hearth Size

- 36"
- 42"
- 46"

Weight*

- 670 lbs
- 706 lbs
- 730 lbs

* Weight based on raw pumice material only.



When considering an Outdoor Fireplace, Isokern has many options available for any outdoor installation. Isokern Fireplaces and Chimney Systems also offer a high insulation value as well as green energy efficiency.

The Magnum, Standard and Vent-Free models can be designed to fit your outdoor living space and can be finished in a variety of materials. Due to its modular make-up Isokern Fireplaces are easily installed and are rated and approved for both wood and gas applications.

Fuel Sources

- ☒ Wood
- ☒ Natural Gas (NG)
- ☒ Liquid Propane (LP)

Firebrick Options

- ☒ Red - Square Edged
- ☒ Red - Tumbled
- ☒ Beige - Square Edged
- ☒ Beige - Tumbled
- ☒ Colonial Brick

Firebrick Patterns

- ☒ Herringbone
- ☒ Stack Bond
- ☒ Basket Weave
- ☒ Running Bond

Finishing Options

- ☒ Natural Stone
- ☒ Colonial Brick
- ☒ Firebrick
- ☒ Stucco
- ☒ Veneers
- ☒ Cultured Stone

Applications

- ☒ Combustible Floor Installation **

Contact your local dealer for additional sizes, specifications and applications.

** Wood Deck Applications - Minimum 4" Air Space Required.

Fireplace Accessories



Earthcore Mortar

Earthcore Mortar adhesive is a thin-set compound used for interior or exterior use. It is an approved adhesive for Isokern fireplace systems and DM chimney components. General uses include ceramic tile, fabricated and cast stone products.

earthcore®
INDUSTRIES, L.L.C.



eDamper

An electronic damper for the IBV (Isokern B-Vent) which addresses both comfort and energy efficiency while allowing complete design flexibility for the look of the hearth. The eDamper eliminates cold drafts by only opening when the fireplace is in use and automatically closes when the fire is turned off. This device is the answer to open damper codes and in price is similar to that of custom glass doors.



ISOFLAMES Gas Log Sets

Finding a gas log set that is sized correctly for your firebox is essential in completing a home's hearth. Log sets not only have to be sized correctly but, also have to look like real wood and burn efficiently. Remote controlled or manual, we offer a large variety of styles and sizes that are perfect for your fireplace.

ISOFLAMES®
GAS LOGS



Firebrick

Firebrick is a refractory brick, capable of sustaining intense heat without fusion. It is usually made of fire clay or of siliceous material. Firebrick is not prone to expansion or contraction, helping to minimize cracking while under extreme heating conditions.

common patterns



herringbone



stack bond

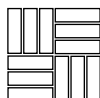

basket weave



running bond

colors



red



beige

(tumbled or square edged)

ISOFLAMES®

GAS LOGS

1.800.642.2920

Isoflames gas log sets include the realistic and natural beauty of actual wood. After extensively researching the logs and branches of trees in their natural environment, the necessary information and data were gathered to ensure that the truest form of realism was replicated for log production. Each log is meticulously created to include cracks, fibers and unique bark knots that are commonly found in natural wood.

Each Isoflames gas log set is masterfully created using only the highest grades of ceramic and steel. Made from a high heat material that allows for greater radiant heat, Isoflames gas logs efficiently add warmth to your room. All log sets are accompanied by a high grade stainless-steel, sand-less burner ensuring a longer life for your log set and providing a clean natural flame.

With an Isoflames gas log set there is no hassle of venturing out into the elements for logs and no ash clean up on your fireplace or hearth. A simple push or turn of a button is all it takes and you can enjoy the warm beauty of natural looking logs anytime.



Technical Information

BTU Output - Vented Logs

Log Sizes		Rustic Ridge & Open Country
18"	NG	57,000 BTU
2 or 4 Burner	LP	28,000 BTU
21"	NG	65,000 BTU
2 or 4 Burner	LP	45,000 BTU
24"	NG	75,000 BTU
2 or 4 Burner	LP	67,000 BTU
30"	NG	80,000 BTU
2 or 4 Burner	LP	69,000 BTU
36"	NG	90,000 BTU
2 or 4 Burner	LP	90,000 BTU

BTU Output - Vent Free Logs

Log Sizes		Canyon Trail - Indoor
24"	NG	40,000 BTU
	LP	40,000 BTU
30"	NG	40,000 BTU
	LP	40,000 BTU

For use with listed ANSI Z223.11.2 unvented decorative room heaters not to exceed 40,000 Btu/hr (11 723 W).

For more information on Isoflames Gas Logs contact us at 800.642.2920 or visit us on the web at www.isokern.net.

Gas Pressure Requirements

Minimum Inlet Gas
Supply Pressure
NG = 5" WC
LP = 10.5" WC

Minimum Inlet
Gas Pressure
NG = 7" WC
LP = 16" WC

Manifold Pressure
NG = 6" WC
LP = 10" WC

NG = Natural Gas
LP = Liquid Propane
WC = Water Column
BTU = British Thermal Unit

www.isofflames.com



Open Country
4 Burner

Sizes

- ☒ 18" ☒ 30"
- ☒ 21" ☒ 36"
- ☒ 24"

Open Country - Vented

The Open Country log style is a combination of different sized logs to appear as if each one was taken from the same tree. Logs with cracks and knots are also included to complete this realistic log style. With burned edges, bark color variances and proper log sizing it is easy to see why the Open Country looks realistic when it is on or off.



Rustic Ridge
2 Burner

Sizes

- ☒ 18" ☒ 30"
- ☒ 21" ☒ 36"
- ☒ 24"

Rustic Ridge - Vented

The Rustic Ridge log style has a beautiful, realistic charred timber wood characteristic to it. With natural misshaped logs and burned edges, the Rustic Ridge offers realism and affordability all in one style.



Canyon Trail
Vent Free

Sizes

- ☐ 18" ☒ 30"
- ☐ 21" ☐ 36"
- ☒ 24"

Canyon Trail - Vent Free

The Canyon Trail vent free log set is perfect for the Isokern Vent Free series, and is available for Indoor fireplaces. This vent free log set can be fueled by either Liquid Propane or Natural Gas and has sensors that automatically turn the unit off when too much gas is escaping.

Accessories



Lava Rock

Lava rock is an accessory that adds beauty, realism and functionality to each log set. These light density, black rocks offer great contrast to your log style and will not absorb the heat that is radiated from the flames. Lava rock is offered with each log set and is ideal when placed underneath and surrounding areas (i.e. bottom of the fireplace) of the log set .



Glowing Embers

Our deep colored ember material is used as an aesthetic addition to complete the view of real wood burning at the bottom of the fireplace. These embers are placed around the log set and burner in an inconsistent, natural looking manner to create that ideal glow under or around each log set. The glowing embers may look like natural material or fibers burning but, due to their fibrous nature will not actually degrade allowing you to use them year after year.

DM Chimney System



1.800.642.2920

The DM or dual module chimney system is a component based chimney system that has an inner liner and an external casing. The modular design of this system allows for more diverse, lightweight chimney installations for fireplaces and other applications. Isokern DM chimney components are built with tongue and groove construction, enabling a tighter fit for maximum safety and consistent installation.

CHIMNEY SYSTEMS



Offset Block

Isokern Offset Blocks offer the ability to move vertical chimney from side to side to pass objects above the firebox. Many current architectural specifications require a diverse chimney system allowing for more custom designs.



Brick Ledge

The Brick Ledge component is uniquely designed to allow a brick or stone chimney to exit out the roof for interior fireplace installations. This component eliminates the cost of having excess masonry carried down the footer.



Chimney Accessories

Copper Chimney Pots

Named after chess pieces, copper chimney pots add a crowning glory to your home. These copper chimney pots are designed to turn an ordinary flue and termination into a fabulous finish that will sit on your roof top for years to come.



Clay Chimney Pots

The perfect termination for any chimney system, clay chimney pots are traditional, simple and have been a mainstay in the fireplace and chimney industry for decades. Efficient, visually appealing and sturdy, clay chimney pots enhance the beauty of any home.



CHIMNEY SYSTEMS

Iso-Cap

Specifically designed to fit the Isokern 14" (fourteen inch) flue liner, Iso-Cap installation is minimal. Each Iso-Cap simply slides into the terminating flue and is sealed with silicone caulk. Installation is easy, clean and quick. Available in copper, black galvanized and stainless steel.

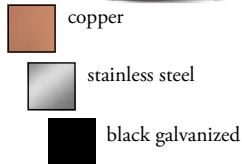

Exhaust Fans

Exhaust fans are used to help control the draught efficiency of your fireplace or appliance improving air quality. These chimney fans feature automatic controls which guarantee optimum chimney draught irrespective of the placing, dimensions or height of the chimney.



Indoor Gallery

1.800.642.2920



FINISHED GALLERY

Outdoor Gallery



Standard Series

	A	B	C	D	E	F	G
36"	43"	25 ¼"	71"	32"	37"	27"	22 ½"
42"	49"	25 ¼"	79"	32"	43"	32"	22 ½"
46"	53"	25 ¼"	71"	32"	47"	37"	33 ½"

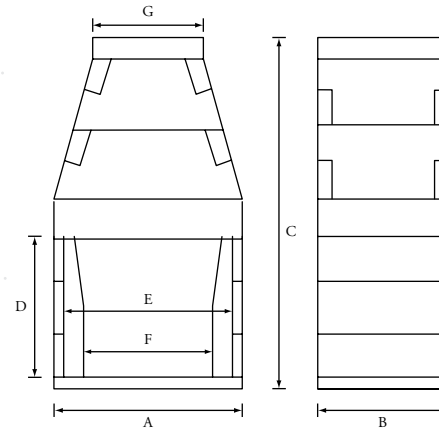

Fire-Lite Application

	A	B	C	D	E	F	G
36"	43"	25 ¼"	75" *	32"	37"	27 ⅞"	22 ½"
42"	49"	25 ¼"	83" *	32"	43"	32"	22 ½"
46"	53"	25 ¼"	75" *	32"	47"	37 ½"	33 ½"

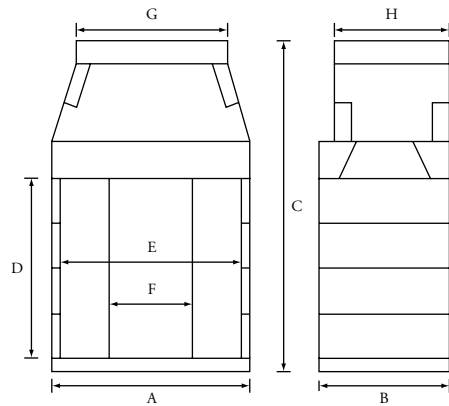

Magnum Series

	A	B	C	D	E	F	G	H
36"	43"	28"	69 ½"	38"	39"	19 ¼"	32 ⅝"	25 ¼"
42"	48 ½"	28"	69 ½"	38"	44 ½"	24 ¾"	32 ⅝"	25 ¼"
48"	53"	28"	69 ½"	38"	49"	29 ⅜"	43"	25 ¼"
60"	73 ½"	28"	85 ½"	38"	69 ½"	50"	54"	25 ¼"
72"	85 ½"	28"	85 ½"	38"	81 ½"	62"	65 ½"	25 ¼"

Fire-Lite Application

	A	B	C	D	E	F	G
36"	43"	28"	73 ½" *	38"	39"	19 ¼"	32 ⅝"
42"	48 ½"	28"	73 ½" *	38"	44 ½"	24 ¾"	32 ⅝"
48"	53"	28"	73 ½" *	38"	49"	29 ⅜"	43"

IBV Series

	A	B	C	D	E	F	G
36"	43"	25 ¼"	71"	32"	37"	27"	22 ½"
46"	53"	25 ¼"	71"	32"	47"	37"	33 ½"

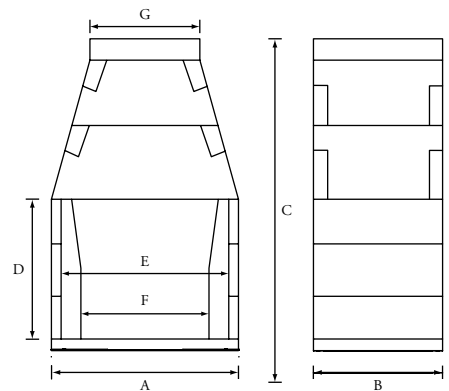

Technical Specifications

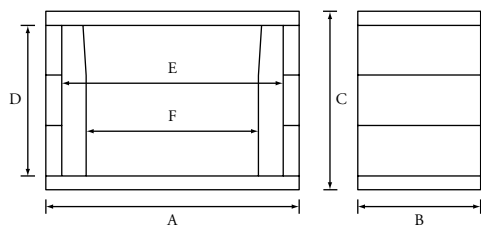

Vent-Free Series

	A	B	C	D	E	F
36"	43"	25 1/4"	38"	32"	37"	27 1/8"
42"	49"	25 1/4"	38"	32"	42"	32 5/8"
46"	53"	25 1/4"	38"	32"	47"	37 3/8"

Fire-Lite Application

*Fire-Lite Application shown on minimum 4" high metal stand required from Earthcore Industries.

"C" Measurements indicate 4" high metal stand.

Approved Anchor Plate required (not shown).

Contact the Technical Department at 800.642.2920 for more information.

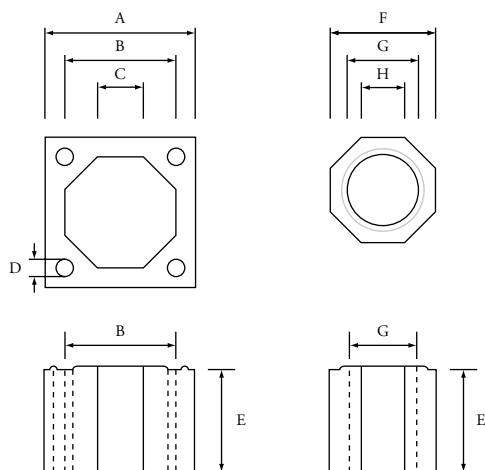
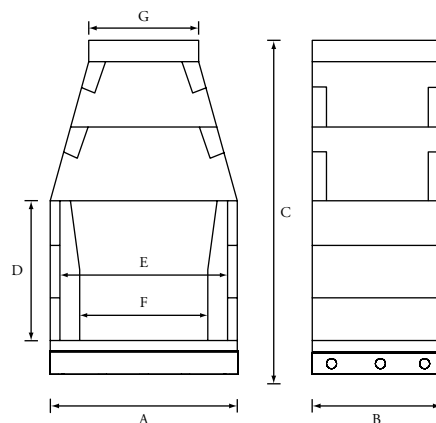
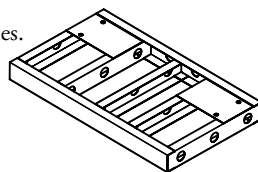

DM Chimney Systems

	A	B	C	D	E	F	G	H
DM44	17 1/4"	12 3/4"	5 1/4"	2"	11 7/8"	12 1/4"	8"	5"
DM54	21 1/2"	17"	7"	2 3/4"	11 7/8"	16 1/2"	14"	6 7/8"

weight*

DM44 80 lbs. per foot

DM54 120 lbs. per foot

- 14" (inch) diameter flue shown left for reference only

- 12" (inch) diameter flue available

* weight based on raw pumice material only

Contact the Architectural / Technical Department at 800.642.2920 for additional sizes, specifications and applications. You can also view our Installation manuals at www.isokern.net for more information on minimum framing & weights.

Standard Series with
DM Chimney

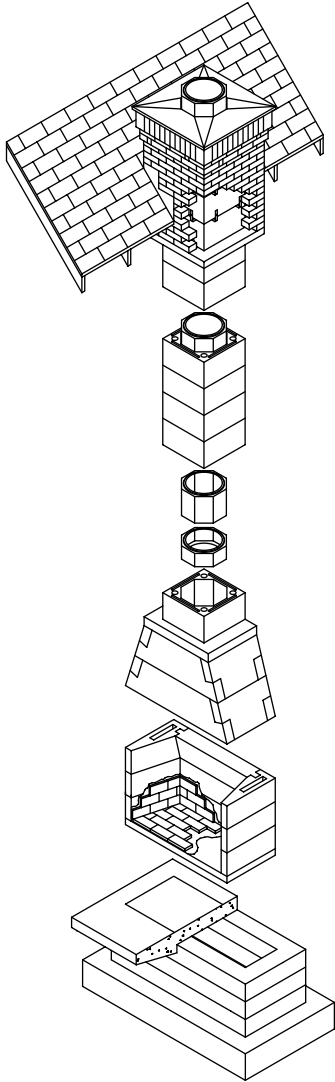

Magnum Series 72" with
Metal Chimney

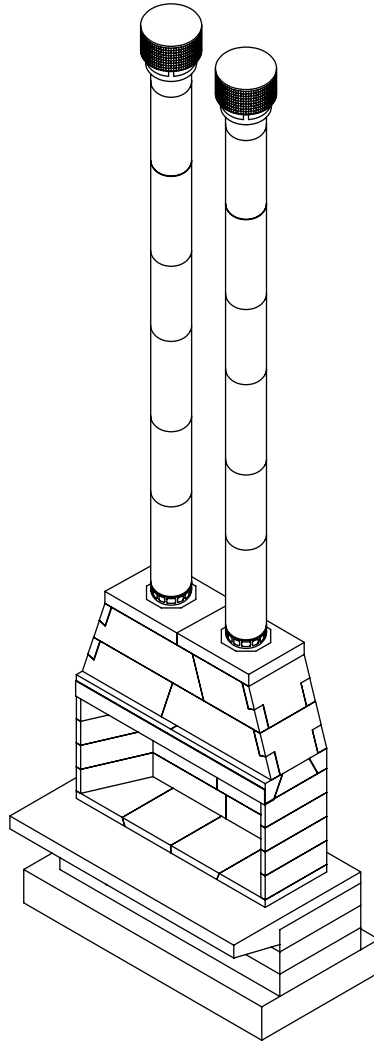

Fire-Lite Series with
Metal Chimney

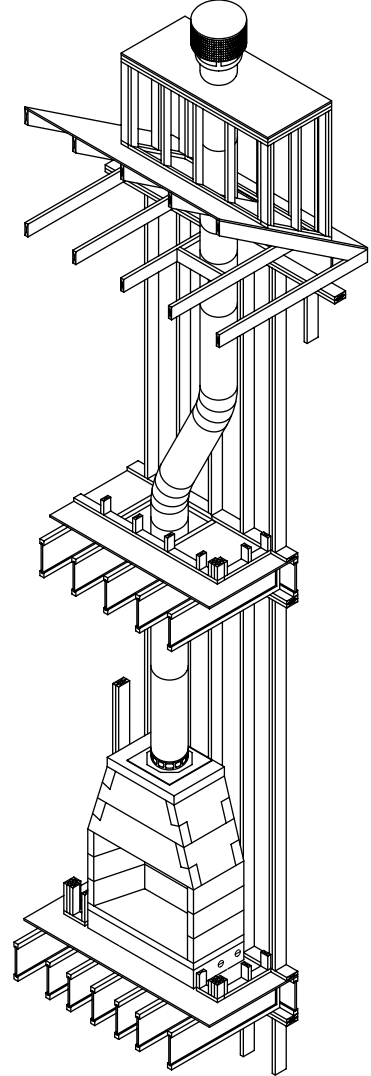

Vent-Free Series with
raised hearth

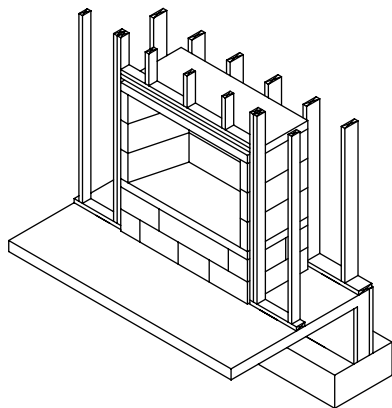

Vent-Free Series with
flush hearth

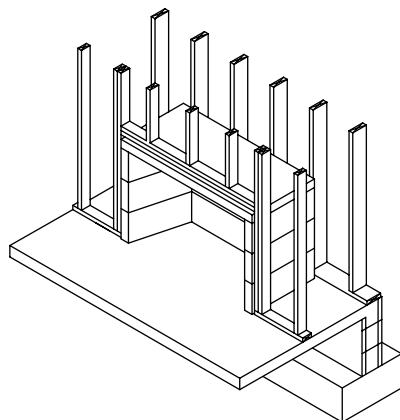

Stacked fireplace application

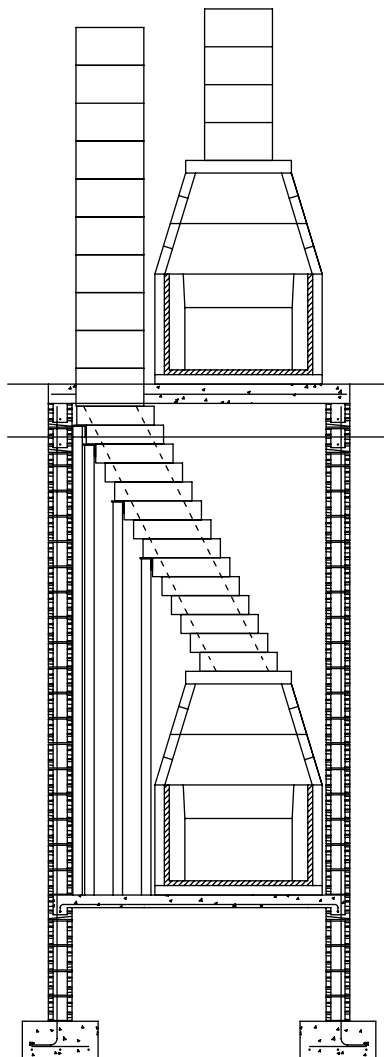

! Technical concepts & photos are for visual and reference purposes only. These drawings are not to be used for technical standards or installation guidelines. Please refer to specific installation manuals for further detailed technical information.

Technical drawings are also available on our website at www.isokern.net. You may also contact an architectural or technical representative at 800.642.2920.

We are proud to be affiliated with some of the best building professionals and businesses nationwide:

Residential:

- Arcadia Homes
- Calvis Wyant Luxury Homes
- Camelot Homes
- Centex Custom Homes
- Conger Builders
- David Weekley Homes
- Darling Homes
- Finton Associates
- Greystone Homes

Residential:

- Hawkins - Welwood Homes
- Ivan Bereznicki Associates
- Kenneth Bealer Homes
- Simonini Builders
- Standard Pacific Homes
- Taylor Woodrow
- Toll Brothers
- William Poole Designs
- Jack Arnold Architects

Commercial:

- Abercrombie & Fitch
- Chevy’s Tex Mex
- Cracker Barrel
- Hampton Inn
- Houlihan’s
- Marriott Residences
- The Plaza Hotel
- Ritz Carlton
- Trump Towers
- Williamsburg Winery
- Williams-Sonoma
- Plaza Hotel NYC

UL listings and building codes

UL 127	ULC S610	IBC 2006
ICC ESR 2316	LA RR NO. 25483	IRC 2006
UL 103HT	NYC-MEA 241-90 E	IMC 2006
ANSI Z223.1	SBCCI 9626	
ANSI Z21.50		

earthcore®

INDUSTRIES, L.L.C.

Earthcore Industries L.L.C is a Jacksonville, Florida based company that manufactures and distributes Isokern brand fireplaces and chimney systems for North America. Along with the Isokern brand, Earthcore Industries also supplies and distributes other fine hearth related products. Since 1987, Earthcore Industries has established 13 sales offices nationwide.



West Division

Las Vegas

6225 S. Valley View Blvd
Suite F
Las Vegas, NV. 89118
p. 702.837.7530
f. 702.837.5670

South Los Angeles

1026 Railroad Street
Corona, CA. 92882
p. 951.738.9702
f. 951.738.9010

North Los Angeles

460 Calle San Pablo
Camarillo, CA 93012
p. 805.484.7350
f. 805.484.7360

Phoenix

3745 E. Wier St.
Phoenix, AZ. 85040
p. 602.454.0900
f. 602.454.6469

Central Division

Austin

2101 East St. Elmo Road
Suite #345
Austin, TX. 78744
p. 512.443.4400
f. 512.443.4410

Dallas

2128 Crown Road
Dallas, TX. 75229
p. 972.247.2311
f. 972.247.1099

Houston

4125 Southerland Rd.
Houston, TX. 77092
p. 713.895.7595
f. 713.895.7747

East Division

Atlanta

3290 Green Point Pkwy
#600
Norcross, GA. 30092
p. 770.409.8911
f. 770.409.8980

Boston

Auburn Industrial Park
2 A Street
Auburn, MA. 01501
p. 508.756.0523
f. 508.752.1894

Charleston

2532 Spruill Ave.
Charleston, SC 29405
p. 843.744.8663

Charlotte

4123 Barringer Dr.
Charlotte, NC. 28217
p. 704.599.6606
f. 704.599.6628

National Headquarters

Jacksonville

6899 Phillips Industrial Blvd.
Jacksonville, FL. 32256
p. 904.363.3417
f. 904.363.3408

Manufacturing Facility

Chesapeake

4000 Holland Blvd.
Chesapeake, VA 23323
p. 757.966.7275
f. 757.966.7275

For your nearest
Isokern dealer call
800.642.2920 or visit
www.isokern.net.



Earthcore Industries services over 600 cities in the United States. For a more comprehensive list of dealers and distributors of the Isokern product in your area, contact us at one of our sales offices or call our 1-800 number listed below.

Albuquerque	Detroit	Montgomery	Portland	Seattle
Birmingham	Jackson	Nashville	Richmond	St. Louis
Chicago	Kansas City	New Orleans	Roanoke	Tulsa
Cincinnati	Miami	Omaha	Salt Lake City	Tuscon
Cleveland	Milwaukee	Philadelphia	San Antonio	Wichita
Denver	Minneapolis	Pittsburgh	San Diego	Wilmington

1.800.642.2920

www.isokern.net

www.earthcoreindustries.com

www.isoflames.com

All products listed in this catalog are supplied or distributed by Earthcore Industries L.L.C.